

# A34 Corridor

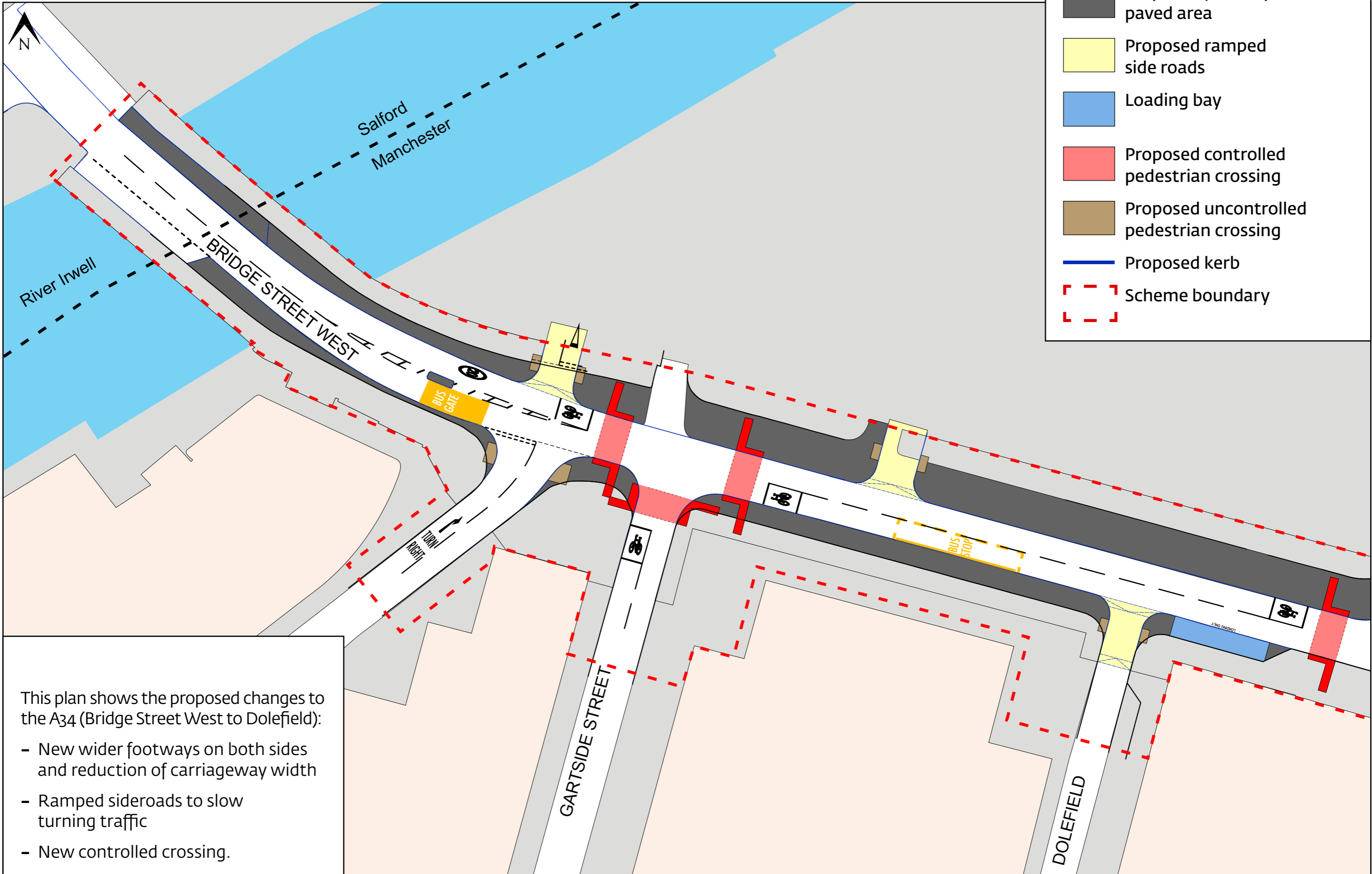

**Key**

- Proposed footway/ paved area
- Proposed ramped side roads
- Loading bay
- Proposed controlled pedestrian crossing
- Proposed uncontrolled pedestrian crossing
- Proposed kerb
- Scheme boundary

This plan shows the proposed changes to the A34 (Bridge Street West to Dolefield):

- New wider footways on both sides and reduction of carriageway width
- Ramped sideroads to slow turning traffic
- New controlled crossing.